

## SVRU Series

### Rotating Wash-Heads for General Purpose Cleaning

The SVRU Series of wash-heads, hydraulically driven by the cleaning solution, are ideal for pipe, barrel, container, enclosed space, or small tank washing. Applications include food production, breweries, wineries, chemical production, pharmaceutical manufacturing, passivation, etc. The SVRU Series combines the most modern engineering and manufacturing techniques with state-of-the-art materials for unmatched versatility, long-term reliability, and low-maintenance operation. Technical support and equipment is available through a wide network of Sellers representatives.

#### Reliability

- No ball bearings
- Designed for simple, quick on-site maintenance as required
- Total quality control of engineering, manufacturing and assembly procedures
- Over 30 years of tank cleaning machine manufacturing experience behind every machine produced

#### Construction

- 316 Stainless Steel and thermoplastic bearings used throughout the machine

#### Flexibility

- Balanced thrust design operates in any position... vertical, horizontal, etc.
- Ideal for general rinsing, pressure cleaning, chemical distribution, and passivation applications



- Fits through small openings
- Reach capabilities up to 16 ft (4.9 m) in diameter
- Suitable for CIP and sanitary applications

**NOTE:** Replace the "X" with either A, B, or C depending upon which model you're working with. For example, the bearing for the Model C is a "131-C"...

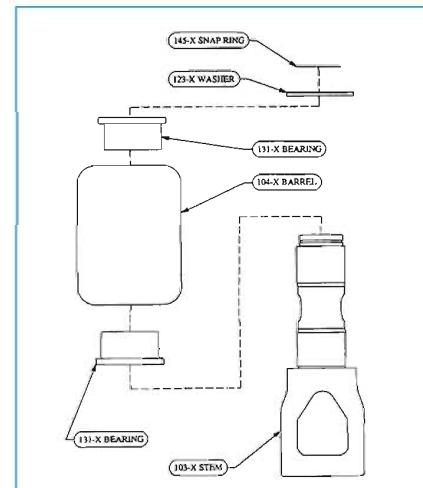



## Rotating Wash-Heads for General Purpose Cleaning

### Specifications



#### SVRU-A

Throw Radius: 3' (0.9 m)  
 Pattern: 2 x 175° Coverage  
 Min. Opening: 1-1/16" (27 mm)  
 Min. Start PSI: 10 (.7 bar)  
 Max Rec PSI: 120 (8.2 bar)  
 Flow Range: 1.3 to 5 gpm (4.9 to 18.9 lpm)  
 Max. Rec. Temperature: 190°F (88°C)  
 Length: 2-5/16" (59 mm)  
 Width: 1-1/16" (27 mm)  
 Weight: 0.34 lbs (.15 kg)  
 Standard Connection: 3/8" NPT female



#### SVRU-B

Throw Radius: 6' (1.8 m)  
 Pattern: 360° Coverage  
 Min. Opening: 1-3/8" (39 mm)  
 Min. Start PSI: 10 (.7 bar)  
 Max Rec PSI: 120 (8.2 bar)  
 Flow Range: 5 to 17 gpm (18.9 to 64.3 lpm)  
 Max. Rec. Temperature: 190°F (88°C)  
 Length: 3-1/2" (88 mm)  
 Width: 1-3/8" (39 mm)  
 Weight: 0.58 lbs (.26 kg)  
 Standard Connection: 1/2" NPT female



#### SVRU-C

Throw Radius: 8' (2.4 m)  
 Pattern: 360° Coverage  
 Min. Opening: 1-5/8" (42 mm)  
 Min. Start PSI: 10 (.7 bar)  
 Max Rec PSI: 120 (8.2 bar)  
 Flow Range: 12 to 38 gpm (45.4 to 143.8 lpm)  
 Max. Rec. Temperature: 190°F (88°C)  
 Length: 4" (102 mm)  
 Width: 1-5/8" (42 mm)  
 Weight: 0.96 (.44 kg)  
 Standard Connection: 3/4" NPT female

### Performance

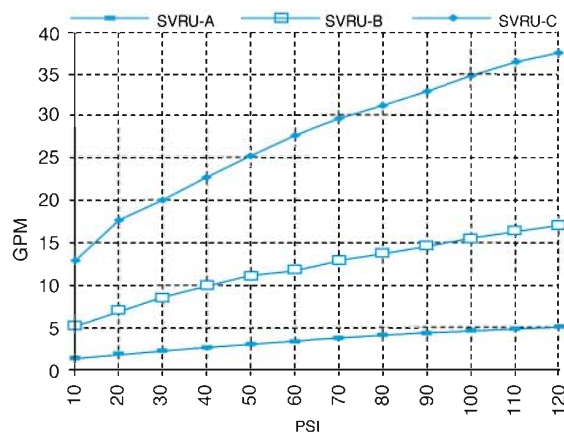

### SVRU-A Wash Pattern

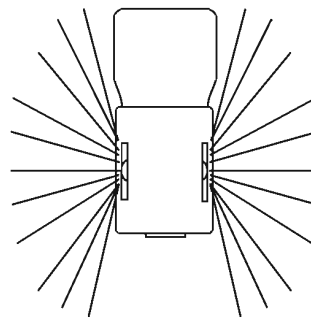

### SVRU-B & SVRU-C Wash Pattern

